

TELEX[®]

FMR-1000 UHF

WIRELESS MICROPHONE SYSTEM

Key Features

- Up to 16 systems can operate simultaneously from the pre-set channels. For more than 16 channels, Telex can help you with the coordination and channel selection.
- Advanced ClearScan™, automatic group and channel selections, for quick and simple system setup.
- Over 950 possible channels.
- Front panel parametric equalizer with Level, Q, and Frequency controls for sound shaping without a mixing board.
- Backlit LCD Display shows the Group/Channel, transmitter battery status, diversity operation, RF and Audio level meters, and space for a custom label.
- Cast magnesium bodypack transmitter, and over-molded Warm-Grip™ handheld transmitter with detachable microphone elements.
- Unique battery circuit means there is no way to put the battery in wrong.
- Patented DSP Posi-Phase™ Diversity System.
- Three Year Warranty

**Power,
Performance
Flexibility,
and Simplicity.**



The FMR-1000 UHF wireless microphone system is a breakthrough frequency-agile system that mixes the power of fully programmable channels with the simplicity of Advanced Clear Scan. With a push of two buttons, Advanced Clear Scan finds the clearest group of channels and you can set up 16 system installations in minutes with confidence you have the clearest channels in the clearest group. A unique sound check screen allows one person to walk test a transmitter with tangible results. For clear vocals, the HT-1000 handheld microphone features a choice between two Electro-Voice™ microphone elements, the N/DYM® 767a dynamic with VOB™ (Vocally Optimized Bass) technology and the new RE 510 professional condenser element.

TELEX® FMR1000 UHF WIRELESS MICROPHONE SYSTEM

SPECIFICATIONS

FMR-1000 Receiver

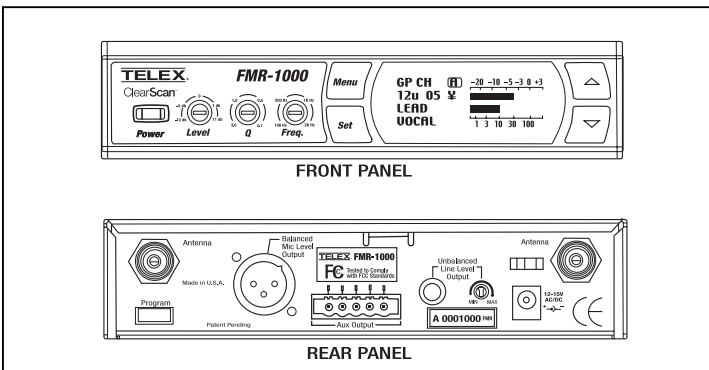

Controls	Front Panel: On/Off, menu, set, up, down buttons, parametric EQ (level -12 dB to + 12 dB, Q 3.0 - 0.1, frequency 100 - 2 kHz)
	Rear Panel: 1/4 inch output level
Indicators	LCD Backlit Display: Group, channel, diversity, label, squelch, set-up screen, transmitter battery level, audio signal amplitude, RF signal strength.
Connectors	Back Panel: 1/4 inch unbalanced adjustable output XLR balanced output USB programming port 5 pin strip connector Pin 1: Transmitter "On" TTL signal Pin 2: Battery low TTL signal Pin 3: Logic ground Pin 4: Unbalanced line level audio output Pin 5: Audio common (ground)
Antennas	Detachable 1/4 wave
RF Specifications	Frequency Range: A Band 680 – 704 MHz (TV Channels 49, 50, 51, 52) B Band 722 – 746 MHz (TV Channels 56, 57, 58, 59) Number of Channels: 950 possible (programmable in 25kHz steps) Diversity: DSP PosiPhase true diversity Receiver Type: synthesized PLL agile UHF RF Sensitivity: <0.8uV for 12 dB SINAD FCC type acceptance: Approved under Part 15
Audio Specifications	Frequency Response: 100 – 15 kHz +/- 2 dB microphone 30 – 15 kHz +/- 2 dB instrument Audio Output Level: Line Level: 8 mV - 0.775V RMS into a 100 k ohm load Balanced: -20 dBV max (@40kHz deviation) Distortion: Less than 0.5% (@1kHz, 40kHz deviation) Signal to Noise Ratio: >110 dB (A) Dynamic Range: >100 dB
General Specifications	Power Supply: External 12 VAC 750mA in-line with cord Size: 1.72" H x 7.50" W x 8.38" D 43.69mm H x 190.50mm W x 212.85mm D

HT-1000 Handheld Transmitter

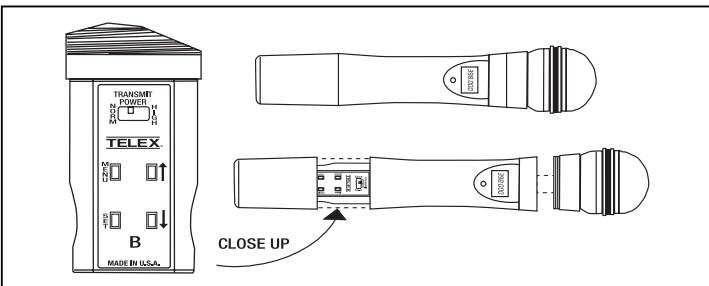

Controls	Power on/off Audio gain adjustment with 26 dB range Transmit power switch Menu, set, up, down buttons
Displays	LCD display (channel and group, frequency, battery level), red LED battery low indicator
Battery Life	8 hours with 9V alkaline (typical)
Antenna	Internal 1/2 wave
Microphone Elements	EV N/D 767a Dynamic or RE 510 Condenser
RF Output	Normal: 5 mW (typical) High: 50 mW (typical)
Size	10.5 in. long (26.8 cm)

WT-1000 Bodypack Transmitter

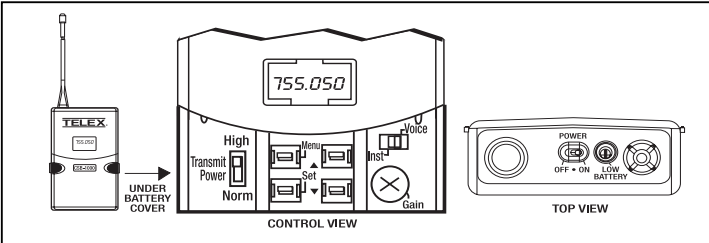

Controls	Power on/off switch Audio gain adjustment with 40 dB range Transmit power switch Microphone/Instrument switch (0, -20 dB) Menu, set, up, down buttons
Indicators	Red LED low battery indicator LCD display (channel/group, frequency, battery level)
Battery Life	8 hours with 9V alkaline (typical)
Antenna	External 1/4 wave detachable
Connector	TA4M input for microphone Pin 1 ground, pin 2 mic input Pin 3 +5V bias, pin 4 +5V through 3k ohm
RF Output	Normal: 5 mW (typical) High: 50 mW (typical)
Case Material	Cast magnesium
Size	4.4 in. x 2.6 in. x .9 in. 111 mm x 66 mm x 23 mm



TELEX COMMUNICATIONS

12000 Portland Avenue South, Burnsville, Minnesota 55337 U.S.A.
TEL: 800-392-3497 • FAX: 952-736-4582

✉ pro.sound@telex.com 🌐 www.electrovoice.com/telex-wireless

SPECIFICATIONS SUBJECT TO CHANGE WITHOUT NOTICE.

©2002 Telex Communications 01/02